

WONDER

Mobility Accessibility Map

Most of the Wonder gallery is accessible to visitors using wheelchairs and other mobility devices.

 AREAS WITH GRADE CHANGES:
• Mess Pit (Grade Level 4 inches)

 WHEELCHAIR ACCESSIBLE

Accessibility Details:

SHINE

Projected Kaleidoscope- Play surface and materials wheelchair accessible.

Light Tables- One of three tables at wheelchair height. Seating removable to allow for wheelchair access.

SPLASH

Water Table- Highest pool surface is fully wheelchair accessible. Lower areas allow for footplate clearance.

Slate Wall- Wheelchair accessible.

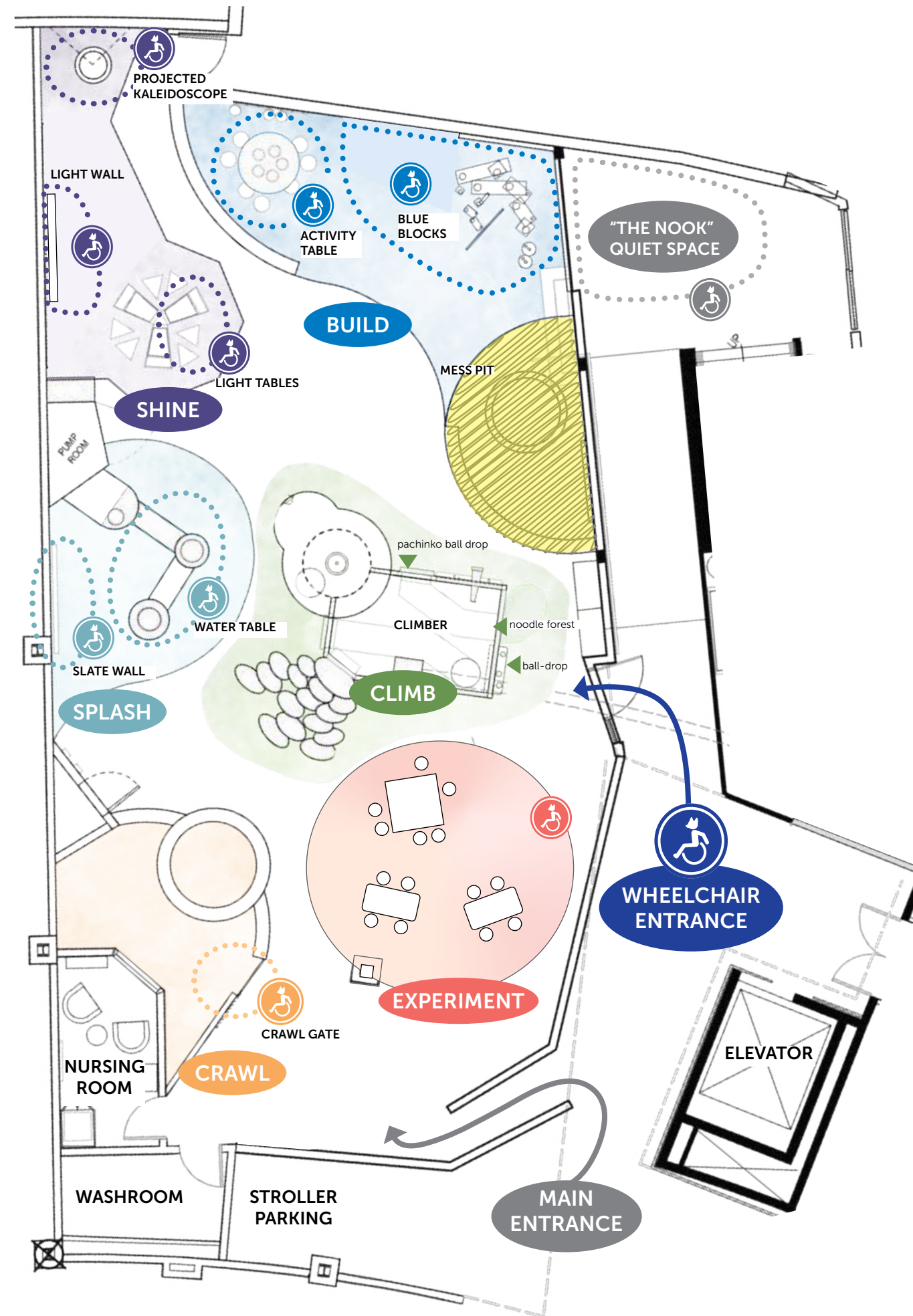

CRAWL

Entrance Gate- Wheelchair accessible sliding gate.

General- Exhibits in this area are built for developing gross motor development

BUILD

Activity Table- Tabletop building activities on a table built at two heights, to accommodate both wheelchair users and non-wheelchair users together.

CLIMB

The Climber- Three ground-level activities integrated into the Climber. These are: noodle forest, ball-drop and the pachinko ball drop.

EXPERIMENT

Activity Table- Tabletop building activities on a low child-height tables.

GENERAL

Washroom- Wheelchair accessible
Change table with 400lbs. load capacity

Nursing Room- Wheelchair accessible
Change table with 400lbs. load capacity.

Stroller Parking- Wonder is a stroller-free zone. If your child requires a stroller for mobility purposes, please use the wheelchair access door.

"The Nook"- A quiet family space with seating.